



Swivel Gear
Cylinders



SB08(Series)

Mounting D MF S

SB08 ST M D MF S

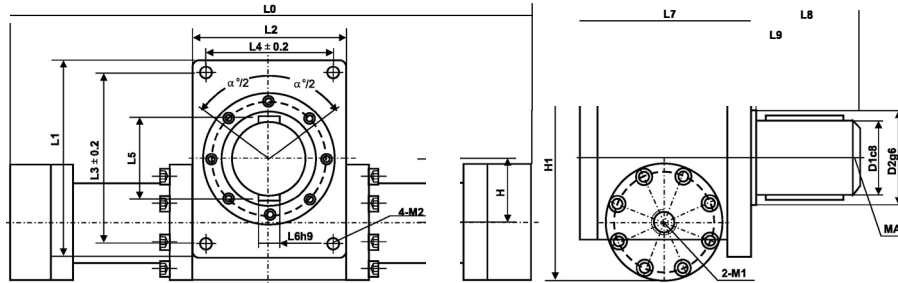

Specifications / technical parameters

Size D MF S (in mm)

DA	MA max	D1	D2	H	H1	L0	L1	L2	L3	L4	L5	L6	L7	L8	L9	M1		
																O1	O2	M2
40	730	70	95	55	197	275+1.54 α 1)	184	164	160	140	79	20	174	105	6	G1/2	M22 × 1.5	M12 × 20
50	1297	80	105	66	231	288+1.75 α 1)	210	170	185	146	90	22	183	125	6	G1/2	M22 × 1.5	M12 × 20
63	2266	90	115	72	253	310+1.92 α 1)	232	194	200	164	100	25	210	140	6	G3/4	M27 × 2	M16 × 25
80	3987	95	125	86	292	370+2.09 α 1)	257	205	225	175	105	25	232	150	8	G3/4	M27 × 2	M16 × 25
100	7476	115	145	100	343	400+2.51 α 1)	306	234	265	194	129	32	264	165	8	G1	M33 × 2	M20 × 30
125	13141	125	155	116	390	464+2.83 α 1)	334	274	285	230	139	32	304	170	8	G1 1/4	M42 × 2	M24 × 35
140	18317	145	180	125	418	484+3.14 α 1)	354	286	305	240	161	36	310	200	10	G1 1/4	M42 × 2	M24 × 35
160	26583	165	200	140	464	511+3.49 α 1)	390	315	330	255	183	40	334	220	10	G1 1/2	M48 × 2	M30 × 45
180	36334	175	220	152	518	584+3.77 α 1)	440	390	380	330	195	45	400	240	12	G1 1/2	M48 × 2	M30 × 45
200	52335	195	240	170	578	611+4.40 α 1)	500	425	440	365	215	45	458	260	12	G1 1/2	M48 × 2	M30 × 45
2203)	92372	200	245	200	660	1338+5.62 α 1)	600	550	520	470	2)	45	560	340	12	G1 1/2	M48 × 2	M36 × 55
2503)	152416	220	275	255	775	1540+7.34 α 1)	700	590	620	510	2)	45	600	380	12	G1 1/2	M48 × 2	M36 × 55
2803)	182900	250	315	300	900	1700+8.34 α 1)	800	690	720	610	2)	50	700	420	12	G1 1/2	M48 × 2	M36 × 55
3203)	325720	320	395	320	980	1920+9.12 α 1)	900	790	820	710	2)	56	750	480	12	G1 1/2	M48 × 2	M36 × 55

Mounting G MF S

SB08 ST M G MF S

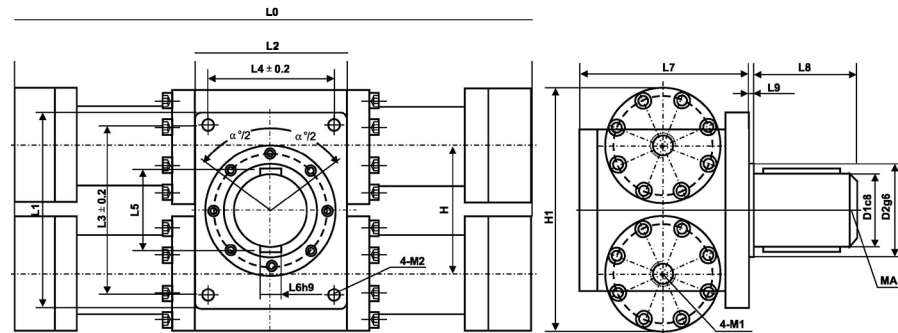

Specifications / technical parameters

Size G MF S (in mm)

DA	MA max	D1	D2	H	H1	L0	L1	L2	L3	L4	L5	L6	L7	L8	L9	M1		
																O1	O2	M2
40	1460	70	95	110	210	275+1.54 α 1)	184	164	160	140	79	20	174	105	6	G1/2	M22 × 1.5	M12 × 20
50	2594	80	105	132	252	288+1.75 α 1)	210	170	185	146	90	22	183	125	6	G1/2	M22 × 1.5	M12 × 20
63	4532	90	115	144	274	310+1.92 α 1)	232	194	200	164	100	25	210	140	6	G3/4	M27 × 2	M16 × 25
80	7974	95	125	172	327	370+2.09 α 1)	257	205	225	175	105	25	232	150	8	G3/4	M27 × 2	M16 × 25
100	14952	115	145	200	380	400+2.51 α 1)	306	234	265	194	129	32	264	165	8	G1	M33 × 2	M20 × 30
125	26282	125	155	232	446	464+2.83 α 1)	334	274	285	230	139	32	304	170	8	G1 1/4	M42 × 2	M24 × 35
140	36634	145	180	250	482	484+3.14 α 1)	354	286	305	240	161	36	310	200	10	G1 1/4	M42 × 2	M24 × 35
160	53166	165	200	280	538	511+3.49 α 1)	390	315	330	255	183	40	334	220	10	G1 1/2	M48 × 2	M30 × 45
180	72668	175	220	304	596	584+3.77 α 1)	440	390	380	330	195	45	400	240	12	G1 1/2	M48 × 2	M30 × 45
200	104670	195	240	340	656	611+4.40 α 1)	500	425	440	365	215	45	458	260	12	G1 1/2	M48 × 2	M30 × 45
2203)	184744	200	245	400	720	1338+5.62 α 1)	600	550	520	470	2)	45	560	340	12	G1 1/2	M48 × 2	M36 × 55
2503)	304832	220	275	510	850	1540+7.34 α 1)	700	590	620	510	2)	45	600	380	12	G1 1/2	M48 × 2	M36 × 55
2803)	365800	250	315	600	1000	1700+8.34 α 1)	800	690	720	610	2)	50	700	420	12	G1 1/2	M48 × 2	M36 × 55
3203)	651440	320	395	640	1060	1920+9.12 α 1)	900	790	820	710	2)	56	750	480	12	G1 1/2	M48 × 2	M36 × 55

Our Long History of Excellence is Your Guarantee of Success



Anker-Holth®

a division of Magnum Integrated Technologies Inc.

200 First Gulf Blvd, Brampton, ON, Canada, L6W4T5

Tel: 905-455-0402 Fax: 905-455-0422

www.ankerholth.com